



999

CAP AND JOINTS FOR SINGLE ELECTRODE HOLDERS

DESCRIPTION

MECHANICAL DIMENSION

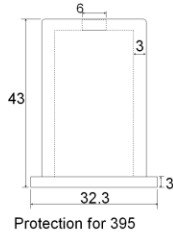

These protections are used when the probes are not waterproof case and it is necessary to protect the wiring.

They are of rigid or soft type (when only small space is available between probes).

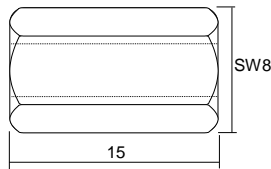

These joints, with nuts and electrodes, allow to extend the sensitive end of the probes, to obtain the desired lengths.

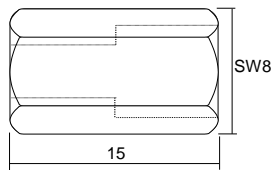

ORDER CODES

| CODE | DESCRIPTION | MATERIAL |
|------------|------------------------|-----------------|
| 999-021-00 | rigid protection | Black nylon |
| 999-011-00 | Joint 4MA x 6MA - SW 8 | stainless steel |
| 999-012-00 | Joint 6MA x 6MA - SW 8 | stainless steel |

Informations provided herein can be changed without notice.

[999_E_CAT3.doc] June-09